

BOSCH

en Safety instructions

Robert Bosch Power Tools GmbH
70538 Stuttgart
GERMANY

www.bosch-pt.com

1 609 92A 4KX (2018.07) 0 / 4



1 609 92A 4KX



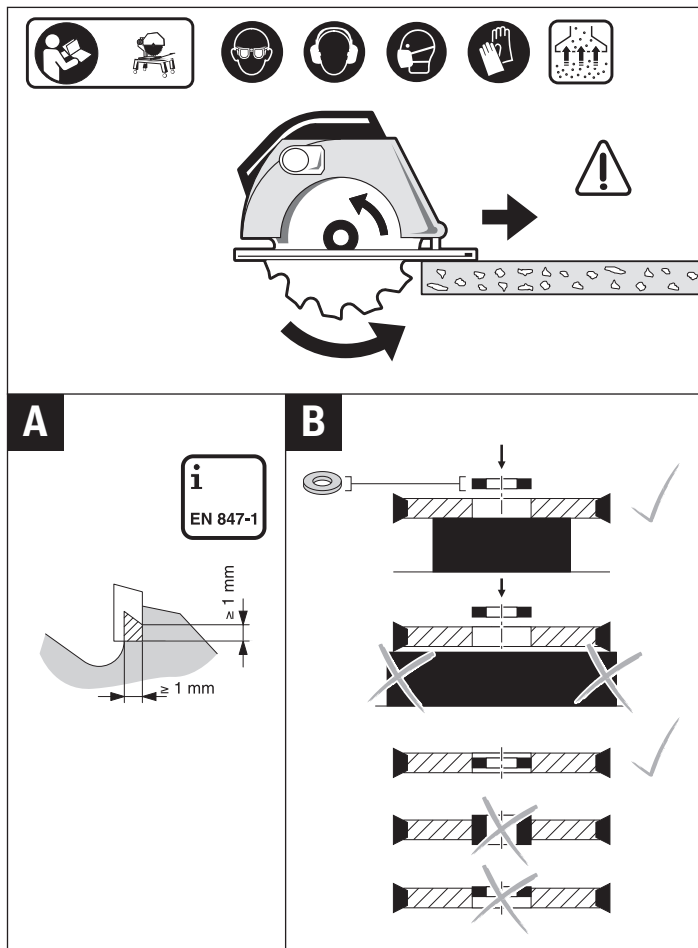

Englisch

Observe the safety warnings of the power tool/woodworking tool being used.

- ▶ This circular saw blade meets the European directive EN 847-1.
- ▶ Select suitable circular saw blades for the material being worked. Observe the material information on the packaging.
- ▶ Observe the thickness of the riving knife and the instructions of the machine.
- ▶ Before using, check the saw teeth, machine settings and rotation direction. Use only saw blades that are in perfect condition.
- ▶ Clean the saw blade regularly.
- ▶ Use suitable protective packaging for storage and transport.

Safe Operation

Maximum speed: The maximum speed given on the circular saw blade may not be exceeded. Observe the speed range (as far as indicated).

TC circular saw blades: Circular saw blades that have cracks or tears in their main body must be replaced. Repairs are not permitted.

TC circular saw blades with saw-tooth dimensions below 1 mm may no longer be used (Figure A).

Steel circular saw blades: Circular saw blades with visible cracks may not be used.

Circular saw blades must be inserted into hand-held circular saws only when the saw is equipped with a self-closing blade guard.

Only use dry cut circular sawing machines to work with ferrous and non-ferrous metals. Use extraction that is permitted for the particular application.

Fastening Circular Saw Blades and Machine Components

When replacing a saw blade, rule out accidental starting of the power tool/woodworking machine.

Mount and secure the circular saw blade in accordance with the regulations of the machine manufacturer. Observe the regulations specified by the machine manufacturer.

Circular saw blades and machine components must be clamped in such a manner that they cannot become loose during operation. Observe the information supplied by the manufacturer.

When mounting the circular saw blade, make sure that the hub of the tool is properly clamped and that the saw blade teeth are not in contact with any part of the machine (no grazing).

Extending spanners or using hammers or similar for tightening purposes is not permitted.

The clamping surfaces must be free of grease, oil and water.

The use of loose-fitting reduction rings or bushings is not permitted.

The use of secure-fitting Bosch rings, e.g. pressed in or held by means of adhesion, is permitted if they are correctly mounted in accordance with figure B (see cover pages).

The ring thickness must always be smaller than the thickness of the base blade body.

Repair of Circular Saw Blades

When repairing, the design of TC circular saw blades may not be changed.

TC circular saw blades may only be repaired through competent persons, i. e. through persons with professional training and experience that know the design and construction requirements and understand the safety regulations to be achieved. For information on the geometry to be observed, please refer to the Online Catalogue under www.bosch-pt.com.

Do not resharpen any "Expert for Stainless Steel" circular saw blades.

Tolerances that ensure perfect clamping must be observed.

Observe valid national and international standards.